

# *Callaghans*

Independent Estate Agents, Surveyors, Valuers and Mortgage Brokers

**63 Eastleigh Road,**  
**Heald Green, SK8 3EJ**



**£299,000**

**Spacious Modern Terrace Property**  
**Gardens, Garage, Driveway**  
**Three Bedrooms**  
**White Kitchen**  
**Modern Bathroom with Walk in Shower**  
**Close to Central Heald Green**  
**Long Leasehold**  
**Council Band D**

Callaghans Estate Agents  
46 Church Road, Gatley, SK8 4NQ  
Telephone: 0161 491 4000, Fax: 0161 491 55 44  
Website: [www.callaghansltd.com](http://www.callaghansltd.com) Email: [admin@callaghansltd.com](mailto:admin@callaghansltd.com)

**Introducing your dream home waiting for you in Heald Green! Callaghans are pleased to offer for sale this spacious three-bedroom modern terrace property, it is the perfect blend of space and convenience. With an inviting entrance hallway, a large open plan living and dining area that opens into the rear Garden. The modern kitchen has white units and integrated sink, oven and Hob. With an integral garage with a driveway, this property ticks all the boxes for your ideal living space. Upstairs, you'll find three well-proportioned bedrooms and a contemporary bathroom with a walk-in shower. Enjoy relaxing or entertaining in the garden at both the front and rear of the property. Best of all? This vacant property is ready and waiting for you to move in - no chain involved! Don't miss out on making this house your home sweet home.**

### **Lounge**

**Kitchen** 12' 4" x 8' 11" (3.76m x 2.71m)

**Downstairs W.C.** 3' 5" x 2' 2" (1.05m x 0.65m)

**Garage** 17' 8" x 8' 11" (5.38m x 2.72m)

**Bedroom One** 14' 11" x 9' 4" (4.54m x 2.84m)

**Bedroom Two** 15' 0" x 8' 11" (4.56m x 2.71m)

**Bedroom Three** 12' 4" x 6' 1" (3.76m x 1.86m)

**Bathroom** 8' 10" x 8' 2" (2.68m x 2.48m)

### **Garden**

**Callaghans Estate Agents**  
**46 Church Road, Gatley, SK8 4NQ**  
**Telephone: 0161 491 4000, Fax: 0161 491 55 44**  
**Website: [www.callaghansltd.com](http://www.callaghansltd.com) Email: [admin@callaghansltd.com](mailto:admin@callaghansltd.com)**

GROUND FLOOR  
558 sq.ft. (51.8 sq.m.) approx.



1ST FLOOR  
453 sq.ft. (42.1 sq.m.) approx.

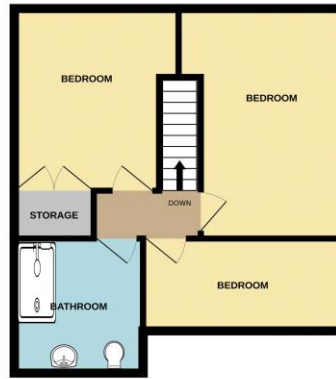

TOTAL FLOOR AREA: 1011 sq.ft. (93.9 sq.m.) approx.

Whilst every attempt has been made to ensure the accuracy of the floorplans contained here, measurements of doors, windows, rooms and any other items are approximate and no responsibility is taken for any error, omission or mis-statement. This plan is for illustrative purposes only and should be used as such by any prospective purchaser. The services, systems and appliances shown have not been tested and no guarantee as to their operability or efficiency can be given.  
Made with Metropac ©2024

**Disclaimer:**

These particulars, whilst believed to be accurate are set out as a general guideline only or guidance and do not constitute any part of an offer or contract. Intending purchasers should not rely on them as statements of representation or fact, but must satisfy themselves by inspection or otherwise as to their accuracy. Please note that we have not tested any apparatus, equipment, fixtures, fittings or services, including gas central heating and so cannot verify they are in working order or fit for their purpose. Further more solicitors should confirm movable items described in the sales particulars are, in fact included in the sale since circumstances do change during marketing or negotiations. Although we try to ensure accuracy, measurements used in this brochure may be approximate. Therefore if intending purchasers need accurate measurements to order carpeting or to ensure existing furniture will fit, they should take such measurements themselves. **YOUR HOME IS AT RISK IF YOU DO NOT KEEP UP REPAYMENTS ON A MORTGAGE OR OTHER LOAN SECURED ON IT**